

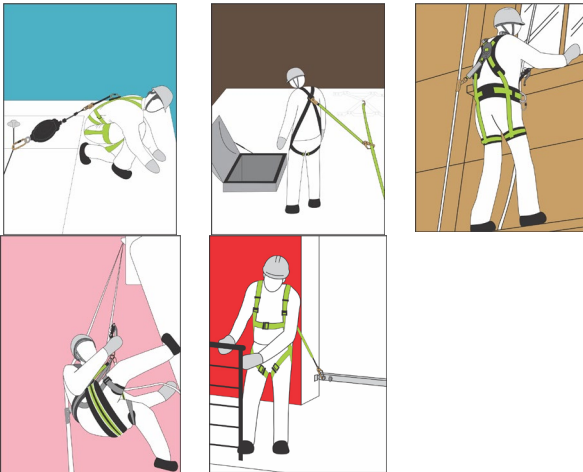

FA 60 027 10

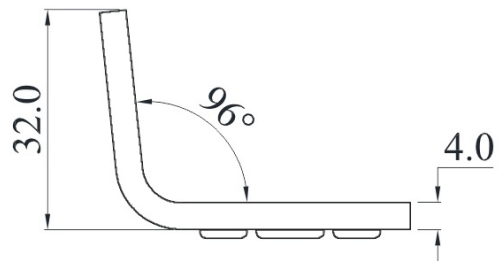

FA 60 027 12

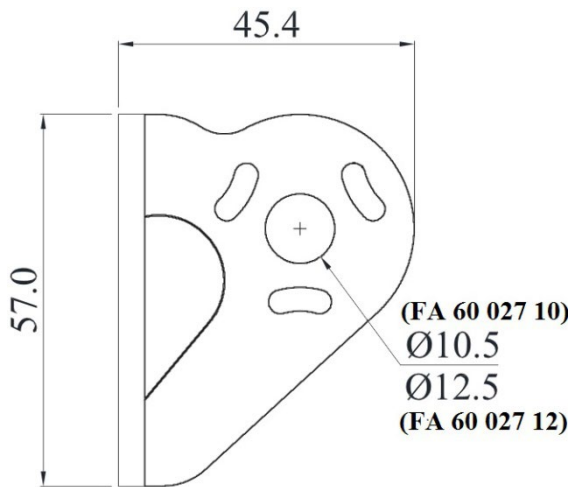
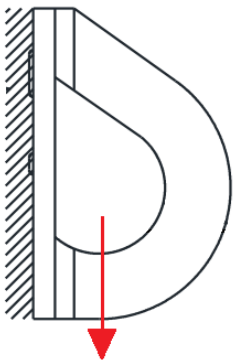

HS CODE
73160010
CARTON SIZE / PCS.
40 x 30 x 24 cm / 100
Certificate of Test n° SPC0240576 / 1548 Extension 1
Satra Technology Centre, N°0321 Wyndham Way, Telford Way, Kettering Northamptonshire, NN16 8SD, United Kingdom
MODULE D FI14/14003.02
SGS Fimko Oy, N°0598 Takomotie 8, 00380 HELSINKI, Finland

REF.	FA 60 027 10	FA 60 027 12
CE	EN 795:2012 Type A	
	x1	
MAT.		
R (kN) / MBS (kN)	12 kN / 23 kN	
	M10 ---	M12 ---
	0.06 KG	0.06 KG

R (kN) / MBS (kN)

Nombre d'utilisateurs
 Number of users
Cantidad de usuarios
 Quantità di utilizzatori
Anzahl der Benutzer

Résistance statique (en kN) / Résistance à la rupture
 Static strength / Minimum Breaking Strength
Resistencia estática (en kN) / Resistencia a la ruptura (en kN)
 Resistenza statica (in kN) / Resistenza alla rottura (in kN)
Statische Festigkeit (in kN) / Bruchfestigkeit (in kN)

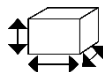

Fixations à utiliser / Dimensions de la structure d'accueil
 Fasteners to use / Dimensions of the receiving structure
Fijaciones que deben usarse / Dimensiones de la estructura receptora
 Elementi di fissaggio da utilizzare / Dimensioni della struttura ospitante
Zu verwendende Befestigungen / Abmessungen der Aufnahmestruktur